

**APPENDIX E-2:**

**On-Lot (Individual or Community) System Analysis**

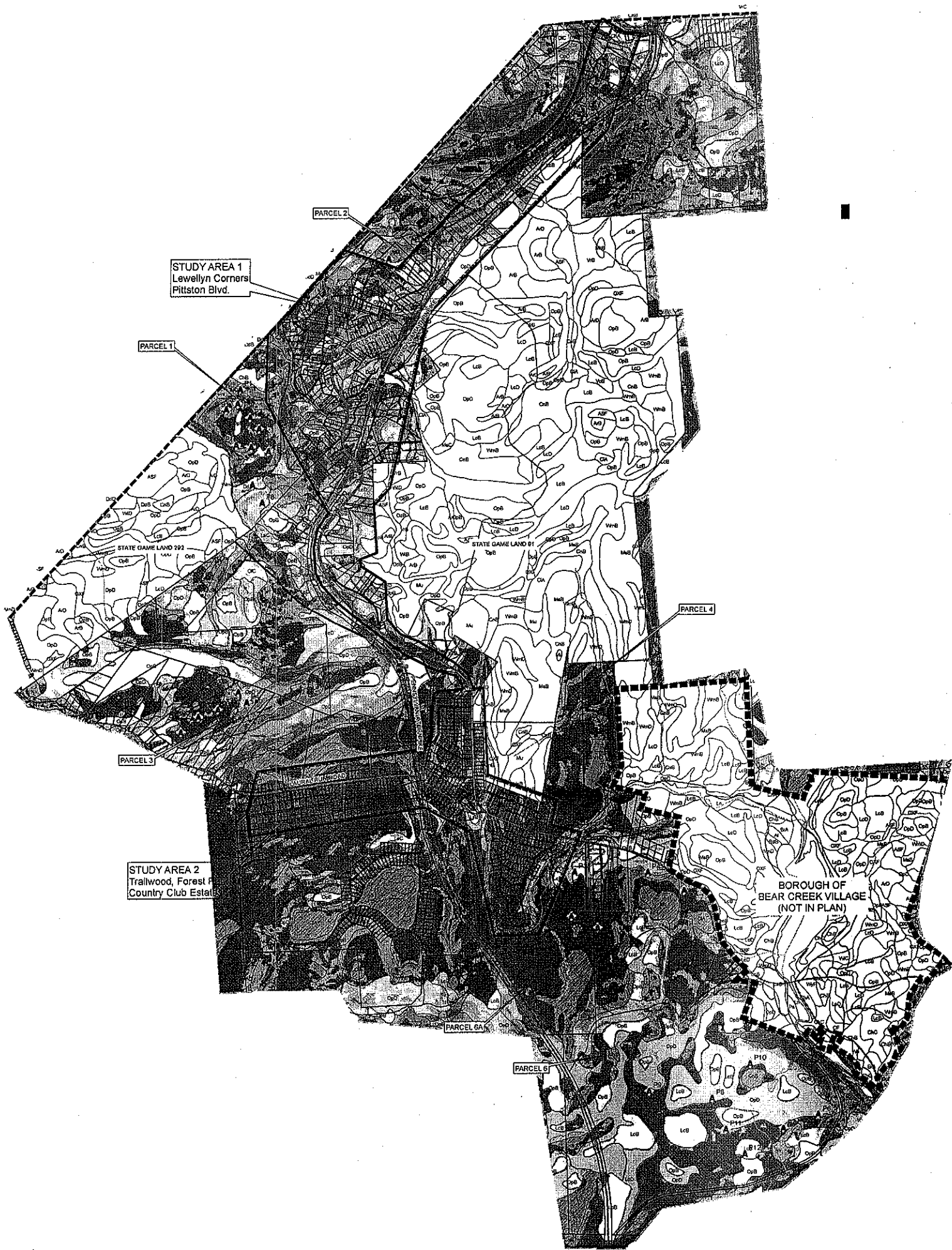

**Legend**

- PLANNING AREA BOUNDARY
- - - INDIVIDUAL STUDY AREAS
- ▲ SOIL PROBE LOCATIONS
- BEAR CREEK TOWNSHIP LINE
- STATE ROADS
- LOCAL ROADS
- RIVERS AND STREAMS
- WETLANDS
- PROPERTY LINES
- WETLANDS

- PERCENT SLOPE**
- 0.00 - 10.00
  - 10.00 - 15.00
  - 15.00 - 25.00
  - > 25.00

- SOIL TYPES**
- SUITABLE
  - MARGINAL
  - UNSUITABLE

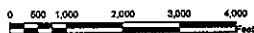

**NOTES:**

1. THIS MAP IS A SMALLER SCALE VIEW OF THE AREA IN AND AROUND BOTH STUDY AREAS TO ALLOW A MORE DETAILED ANALYSIS OF THE SOILS IN THIS AREA.
2. SOILS SUITABILITY IS DETERMINED BASED ON THE CRITERIA FOR A LAND BASED ON LOT SYSTEM ANALYSIS. THE DIFFERENT SOILS DESCRIPTIONS AND SUITABILITY CRITERIA ARE INCLUDED IN SECTION 4.4.1(C) AND 4.4.1.
3. SOIL PROBE DATA AND PARCEL INFORMATION IS INCLUDED IN APPENDIX E.3.
4. SOIL INFORMATION IS STATE GAME LANDS NOT SHOWN BECAUSE STATE GAME COMMISSION WOULD NOT ALLOW LAND APPLICATION SYSTEM ON THEIR LANDS.

BEAR CREEK TOWNSHIP  
 LUZERNE COUNTY, PA  
 ACT 537 PLAN UPDATE  
 APPENDIX E-2  
 SOILS MAP FOR  
 ON-LOT (INDIVIDUAL OR COMMUNITY)  
 SYSTEM ANALYSIS

**Reilly**  
 ASSOCIATES  
 ENGINEERING / ENVIRONMENTAL / SURVEYING  
 49 South Main Street  
 Suite 200  
 Pittston, PA 18640  
 Tel: 610.654.2475  
 Fax: 610.654.9500  
 www.reillyengineering.com