

APPENDIX E-1:
Spray System Analysis

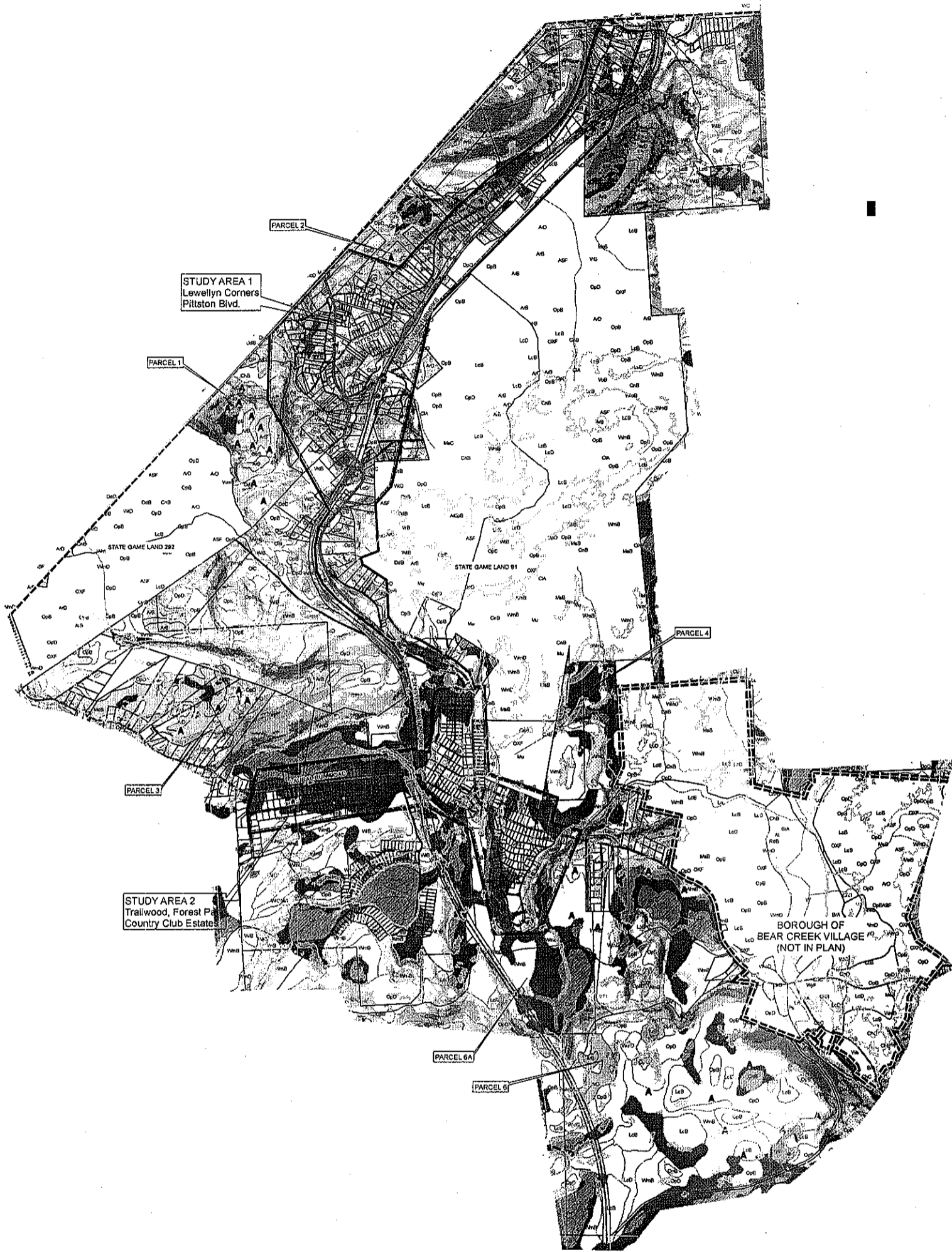

Legend

- PLANNING AREA BOUNDARY
- INDIVIDUAL STUDY AREAS
- P1 SOIL PROBE LOCATIONS
- BEAR CREEK TOWNSHIP LINE
- STATE ROADS
- LOCAL ROADS
- RIVERS AND STREAMS
- PROPERTY LINES
- WETLANDS / WATER BODIES

PERCENT SLOPE

- 0.00 - 10.00
- 10.00 - 15.00
- 15.00 - 25.00
- > 25.00

SOIL TYPES

- SUITABLE
- MARGINAL
- UNSUITABLE

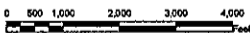

NOTES:

1. THIS MAP IS A SMALLER SCALE VIEW OF THE AREA IN AND AROUND BOTH STUDY AREAS TO ALLOW A MORE DETAILED ANALYSIS OF THE SOILS IN THIS AREA.
2. SOIL SUITABILITY IS DETERMINED BASED ON THE CRITERIA FOR A LAND BASED SPRAY IRRIGATION SYSTEM ALTERNATIVE. THE DIFFERENT SOIL DESCRIPTIONS AND SUITABILITY CRITERIA ARE INCLUDED IN SECTION 441.C AND 4.V.I.
3. SOIL PROBE DATA AND PARCEL INFORMATION IS INCLUDED IN APPENDIX E.3.
4. SOIL INFORMATION IS STATE GAME LANDS NOT SHOWN BECAUSE STATE GAME COMMISSION WOULD NOT ALLOW LAND APPLICATION SYSTEM ON THEIR LANDS.

BEAR CREEK TOWNSHIP
 LUZERNE COUNTY, PA
 ACT 537 PLAN UPDATE
APPENDIX E-1
SOILS MAP FOR
SPRAY SYSTEM ANALYSIS

Reilly
 ASSOCIATES INC. 1992
 SURVEYING / CIVIL ENGINEERING / SURVEYING
 49 South Main Street
 Suite 200
 Pittston, PA 16840
 Tel: (717) 854-2172
 Fax: (717) 854-8000
 www.reillyengineering.com